

BAT R/T MILLENNIUM

Battery or Loop Powered Ratemeter & Totalizer

Features

- Accepts Inputs From: Magnetic Pickups, Contact Closures, DC Pulses (Optically Isolated) from Pulse Producing Flowmeters
- Displays Rate & Total Simultaneously
5 Digit Rate Display, 8 Digit Totalizer Display
- 4-20mA Analog Output Option (8 updates/sec)
- Powered From Internal Battery, External DC Supply or 4-20 mA Output Loop
- 20 Point Linearization (optional);
10 Point Linearization with Data Logger option
- Isolated Scaled Pulse Output
- Nonvolatile Flash Memory of Setup Data
- RS485 Modbus RTU Communications and Data Logger (S2 option)
- Setup Software Available for Easy Programming and Monitoring Using a PC and Special Serial Cable (S1 option)
- Explosion Proof CSA or UL/C-UL Intrinsically Safe Listed

Description

Featuring 5 digits of rate and 8 digits of total, the BAT R/T Millennium edition (BATRT-M) is a battery or loop powered indicator capable of accepting magnetic pickup, DC pulse and switch closure inputs from pulse producing flowmeters. The unit can be ordered with an optional 4-20mA output. The BATRT-M uses the 4-20mA loop to provide power when this output is used.

Specifications

DISPLAY:

Rate Display: (selectable decimal)

5 Digits (99999), 0.35" High, Display updates once per second with battery power, 8X per second with DC or Loop power

Rate Descriptors: /SEC, /MIN, /HR
/MIN, /HR, /DAY with "D" option

Min. Input Frequency: 0.01 Hz to 10 Hz (selectable delay of 0.1 to 99.9 seconds) Selectable Rate Display Damping

Totalizer Display: (selectable decimal)

8 Digits (99999999), 0.2" High

Totalizer Descriptors: GAL, LIT, FT3, M3, "blank"
GAL, BBL, MCF, M3, "blank" with "D" option

Warning Displays: Low battery warning

PULSE OUTPUT:

The pulse output advances with the least significant digit of the totalizer or decimal multiples thereof (see Pulse scale divider).

Type: Isolated photomos relay

Max. voltage (off state): 30 VDC

Current (on state): 100mA

Pulse Duration: Selectable 0.5, 0.25, 0.125, 0.0625 seconds

Pulse Scale divider (Pulscale): User selectable, $\div 1$, $\div 10$, $\div 100$ or OFF

NOTE: Select OFF for max. battery life.

ACCURACY:

0.01% Reading, ± 1 count

Temperature Drift: 50 ppm/ $^{\circ}$ C Worst Case

SAFETY LISTINGS (Mounting Styles 3, 3NE, 3SS):

CSA File 091109 (cert. 1120094)

UL/C-UL File E225832

CLASS 1, DIV 1, GROUPS B, C, D

Additional "enclosure only" approvals available for ATEX and IEC



Mounting Style 1



Mounting Style 2



Mounting Style 3NE



Mounting Style 3SS



Mounting Style 5



Mounting Style 6



PIC Engineering And Services (002110838-X)

No. 72, Jalan Keluli AN7/AN,
Pusat Perniagaan Bukit Raja, Seksyen 7 40000
Shah Alam, Selangor D.E., Malaysia

Tel: +6019 338 8819 Fax: +603 3343 8819

Email: sales@picengineering.com.my

Website: www.picengineering.com.my

BATPACK

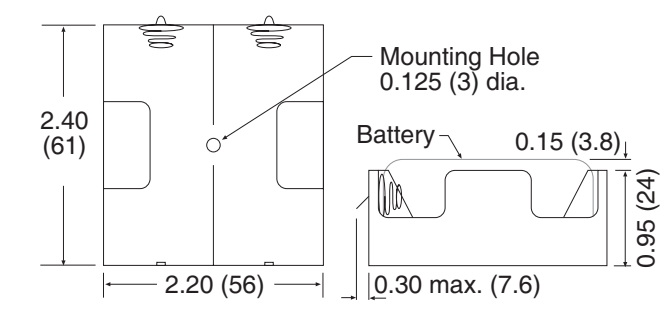

BATRT-M-3NE

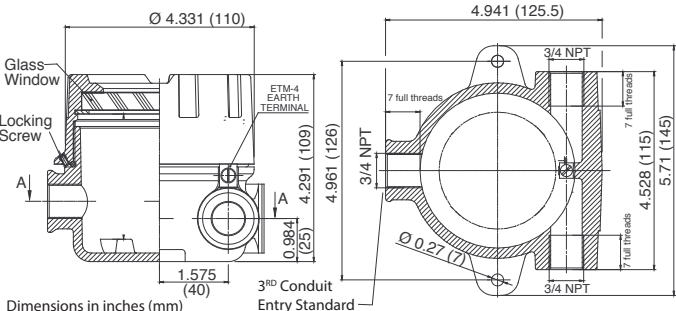

BATRT-M-0

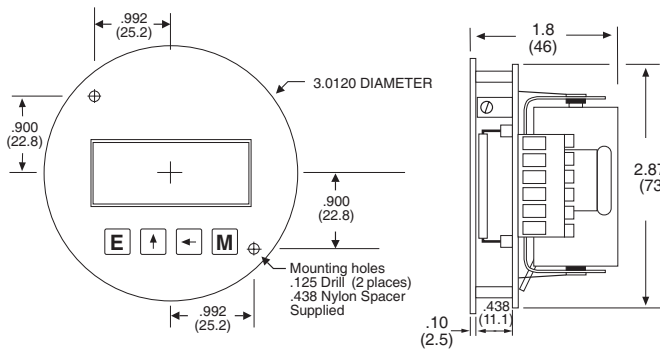

BATRT-M-3SS

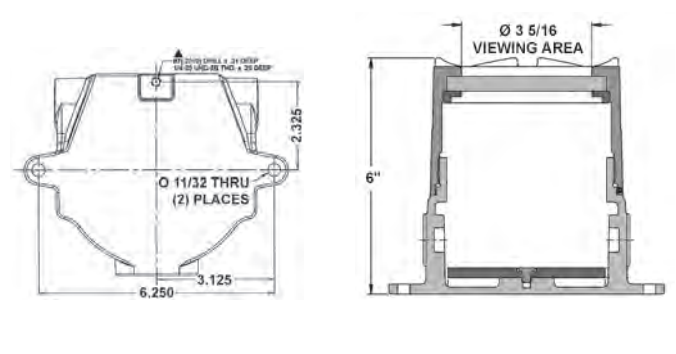

BATRT-M-1

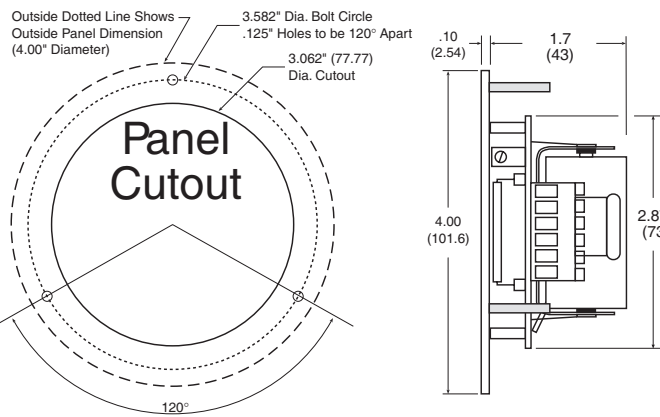

BATRT-M-5

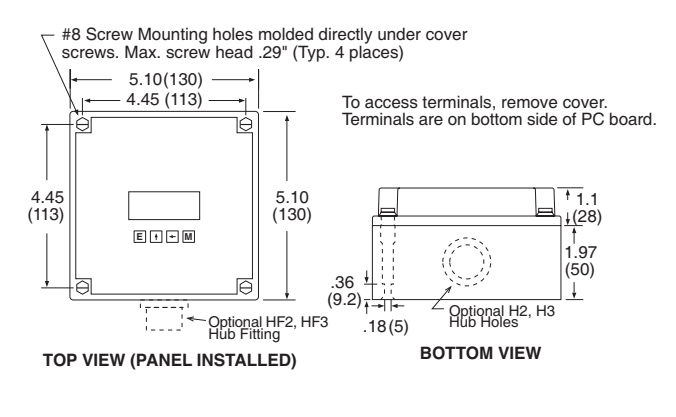

BATRT-M-2

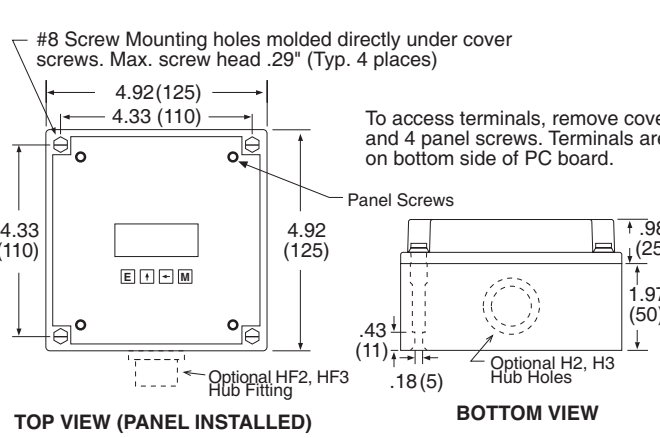

BATRT-M-6

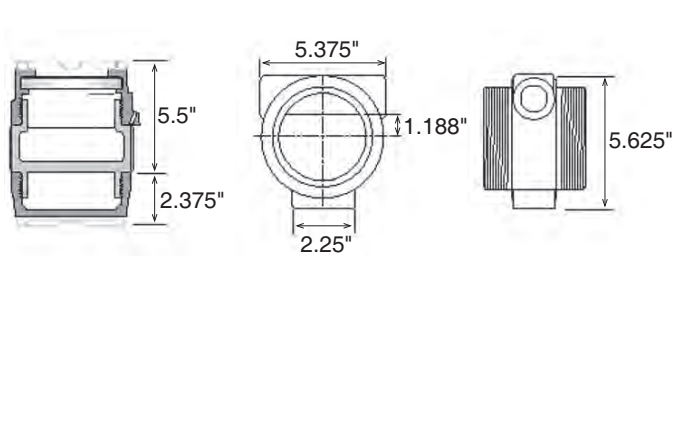

NOTE: Additional entry holes may be provided on styles 2 and 5.

Typical Wiring:

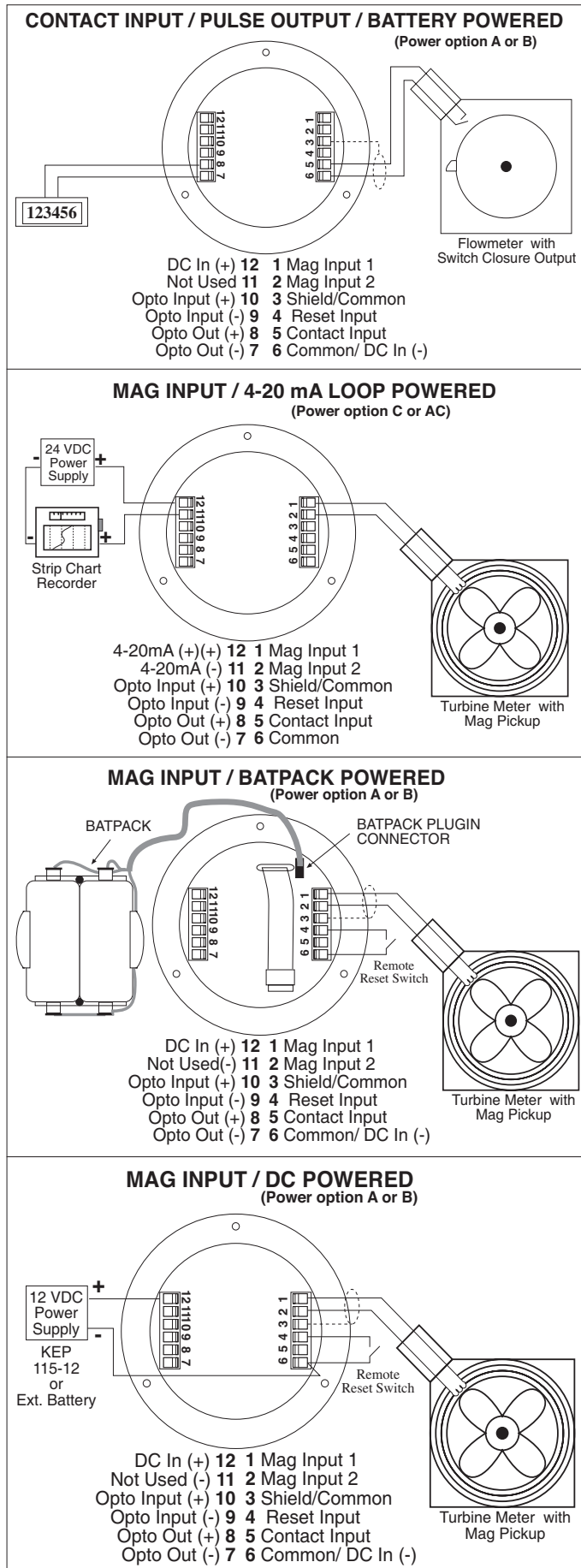

Ordering Information

EXAMPLE: BATRTM 3 A 4 ET

Series: _____
Mounting: _____
† 0 = OEM
† 1 = Panel Mount
2 = NEMA 4X Box (BAT R/T behind clear cover)
3NE = Explosion Proof Housing, White
Includes Third Conduit Entry
3SS = Stainless Steel Ex-Proof Housing (consult factory)
5 = NEMA 4X Box (BAT R/T outside opaque cover)
6 = Double Ended Explosion Proof Housing

Power Supply: _____
† A = Battery (2 supplied)
B = External Power Supply (8.5 to 30 VDC)
C = Loop Powered with 4-20 mA Output
AC = Loop Powered with 4-20 mA Output and 2 Batteries

Options (Multiple Options Available) _____
S1 = Serial Setup Software for use with BSAC1
S2 = RS485/Modbus/Data Logger - Isolated
(power options B, C only)
4 = 20 Point Linearization (10 point with S2 option)
D = Rate per Day, Hour or Minute
ET = Extended Temp.: -22°F to 158°F (-30°C to 70°C)
CE = CE Approved Version (LVD & EMC only)
CSA = CSA Approved Version (explosion proof)
IS** = UL Listed IS (consult factory)
ATEXCASE** = European Flame Proof
ATEX Case (consult factory)
TRX = NEMA7 Explosion Proof Reset Switch
on Third Conduit Entry (mounting style 3 only)
RN = External Magnetic Reset
H2 = 0.875" Hole for mounting styles 2 and 5
HF2 = 0.5" Female NPT Hub fitting (mount styles 2 & 5)
H3 = 1.125" Hole for mounting styles 2 and 5
HF3 = 0.75" Female NPT Hub fitting (mount styles 2 & 5)

Special Battery Options

NB = No Battery
AB = Supplied with A size batteries

Accessories:

BATPACK = External Batt. Pack with
2 C Size Batteries & 12" leads
BATC = Single Battery: Tadiran P/N TL2200/S
3.6V 7200mAh or equal
115-24 = 115 VAC to 24 VDC power supply
BSAC1 = RS232 Serial Adapter Cable
with setup software
TFMMK-1 = Turbine Flowmeter Mounting Kit
for flow meters with a 1" Male NPT riser
TFMMK-3/4 = Turbine Flowmeter Mounting Kit
for flow meters with a 3/4" Male NPT riser
CA-TFM-2-18FL = 18" Long Turbine Flowmeter
Cable Assembly

† External battery pack supplied with models BATRTM0A & BATRTM1A
** Contact factory for latest information

RoHS Compliant planned